

Dahua AR DH-AR306-E Enterprise Router Installation Quick Start-AP100

BOM: 3122A0K9

Tool list

The installation tools are not provided with the router. Prepare them yourself as required.

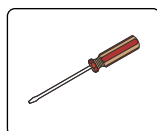

Flathead screwdriver

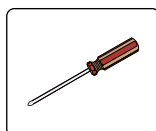

Phillips screwdriver

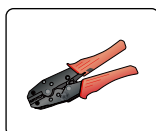

Wire-stripping pliers

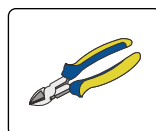

Diagonal pliers

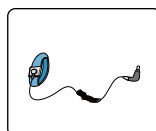

ESD wrist strap



Heat gun

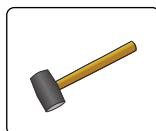

Rubber hammer

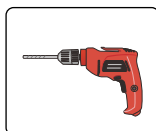

Drill

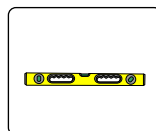

Ruler

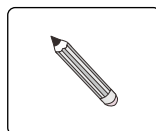

Marker

Installation accessories

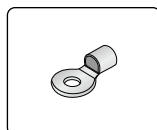

Ring terminal

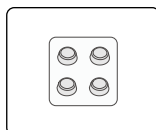

Rubber feet

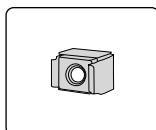

Cage nut
(user supplied)

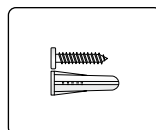

Wall anchor and screw
(user supplied)

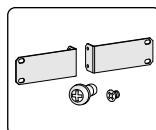

Mounting brackets and screws
(optional)

Wear an ESD wrist strap, and make sure the wrist strap makes good skin contact and is reliably grounded.

Wall-mounting the router



- When you mount the router on a wall, make sure the Ethernet ports face downwards and the two sides with ventilation holes are perpendicular to the ground.
- The screw anchors are compatible with the screws.

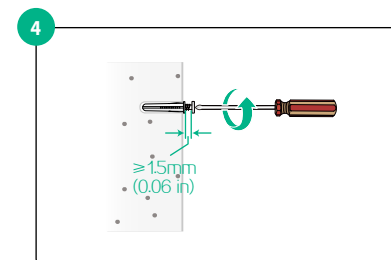
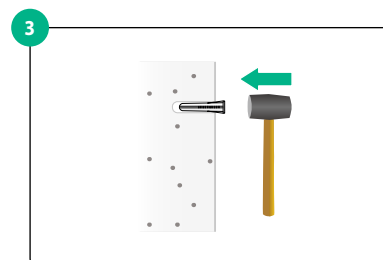
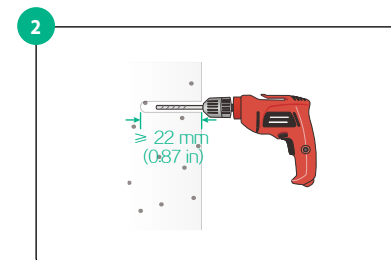
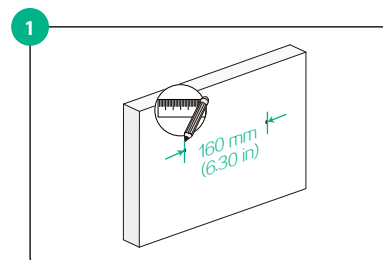
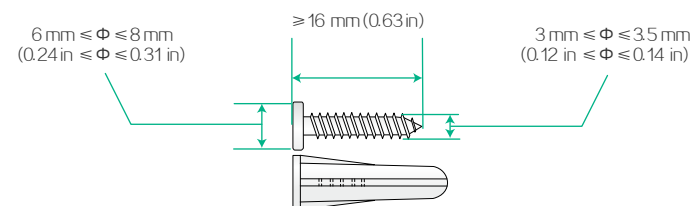

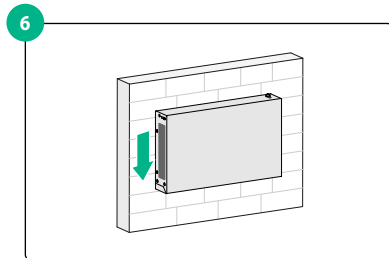
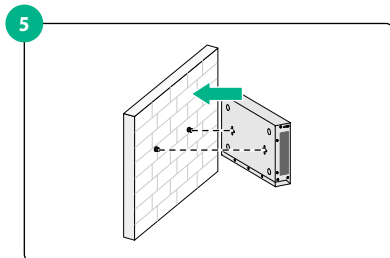

Rack-mounting the router



No mounting brackets or screws are provided with the router. Purchase them yourself.

Install cage nuts.

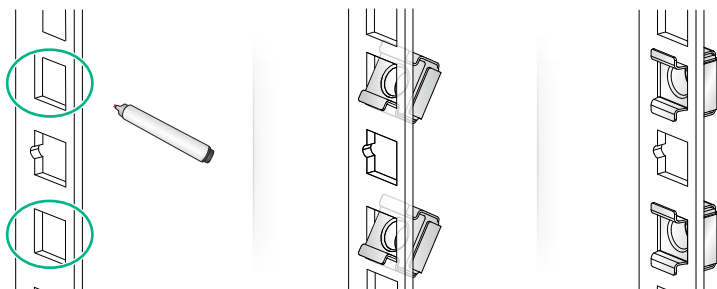

Attach the mounting brackets to the router.

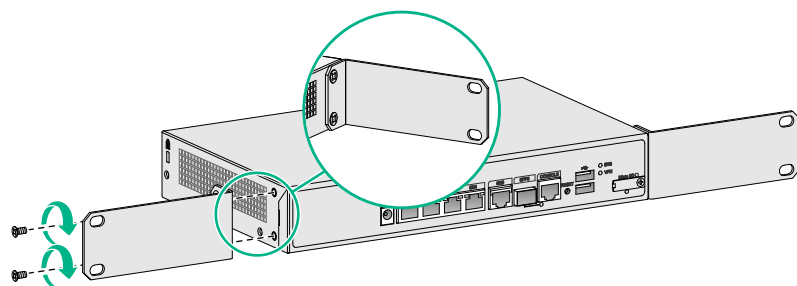

Mount the router in the rack.

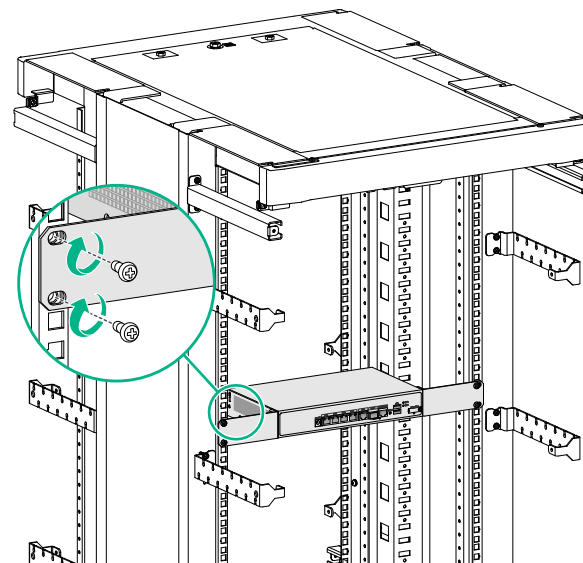

Workbench-mounting the router

Attach the rubber feet to the router bottom. Then place the router on the workbench upside up.

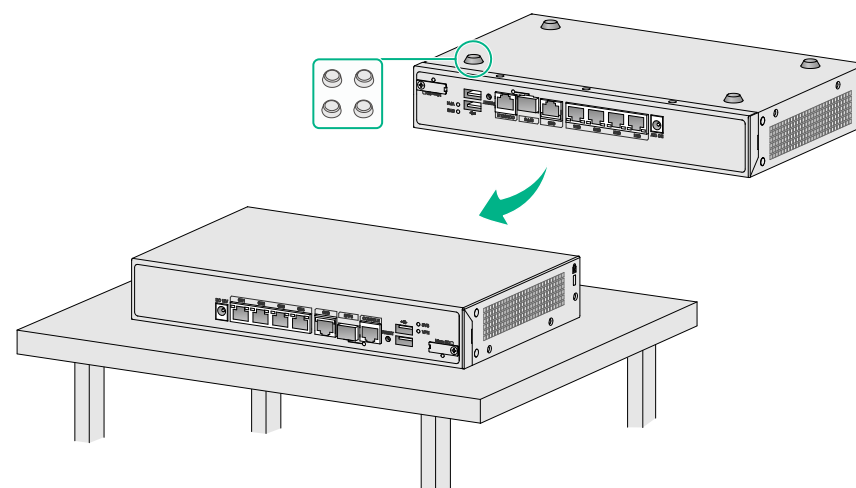

Installing a micro SD card

Remove the micro SD card slot cover, insert the card into the slot, and reinstall the cover.

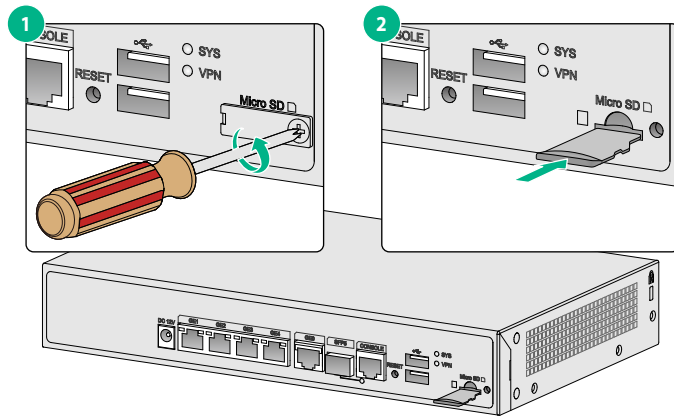

Connecting the grounding cable to the router



Correctly connecting the grounding cable is crucial to lightning protection and EMI protection. Attach the ring terminal provided with the router to the grounding cable. Make sure the grounding cable is reliably grounded.

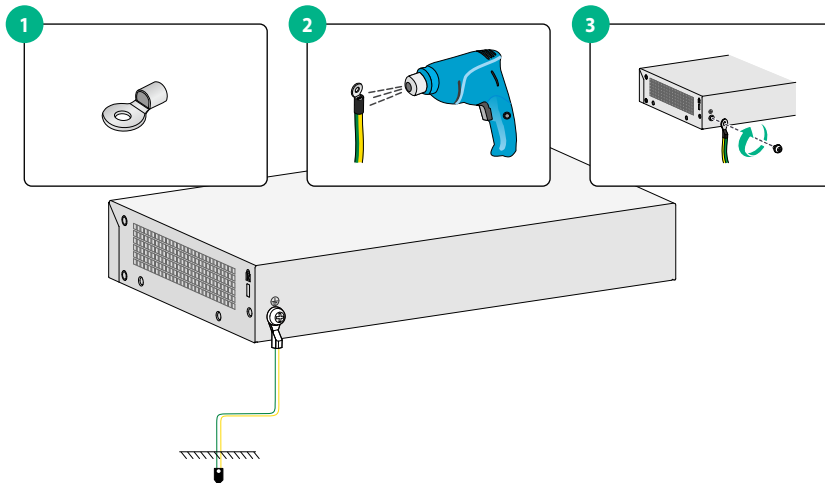

Connecting the power adapter



- Before connecting the power adapter, make sure the router is reliably grounded.
- To avoid bodily injury, first connect the power adapter to the router and then to the equipment-room power supply system.

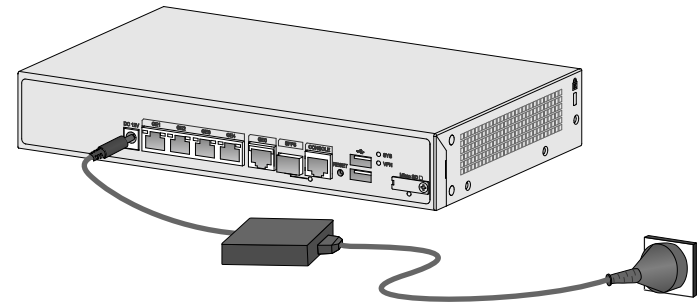

Connecting an Ethernet cable

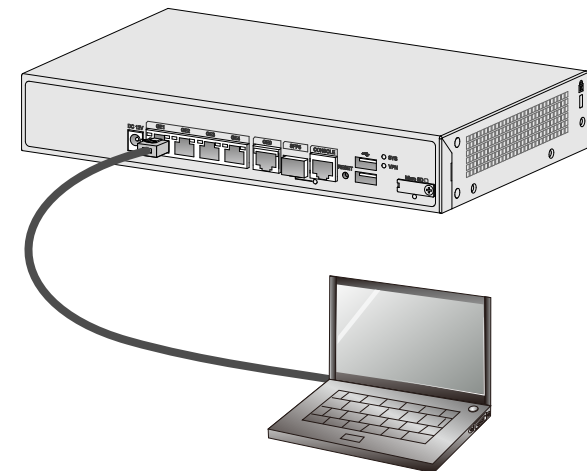

Connecting the router to a configuration terminal by using the console cable

